

分割撮影ターゲット

| | | | | | | | |
|---------------------|--|---|---|---|---|---|---|
| 分割した 部分の 撮影順序 | <table border="1" data-bbox="606 795 1252 1019"><tr><td>1</td><td>2</td><td>3</td></tr><tr><td>4</td><td>5</td><td>6</td></tr></table> | 1 | 2 | 3 | 4 | 5 | 6 |
| 1 | 2 | 3 | | | | | |
| 4 | 5 | 6 | | | | | |
| 分割撮影 した理由 | A 3 判 以 上 の た め | | | | | | |
| 上記のとおり分割撮影した事を証明する。 | | | | | | | |

0672
0673
0674

0675
0676
0677

小富士航空隊

Chart, showing the position of equipment

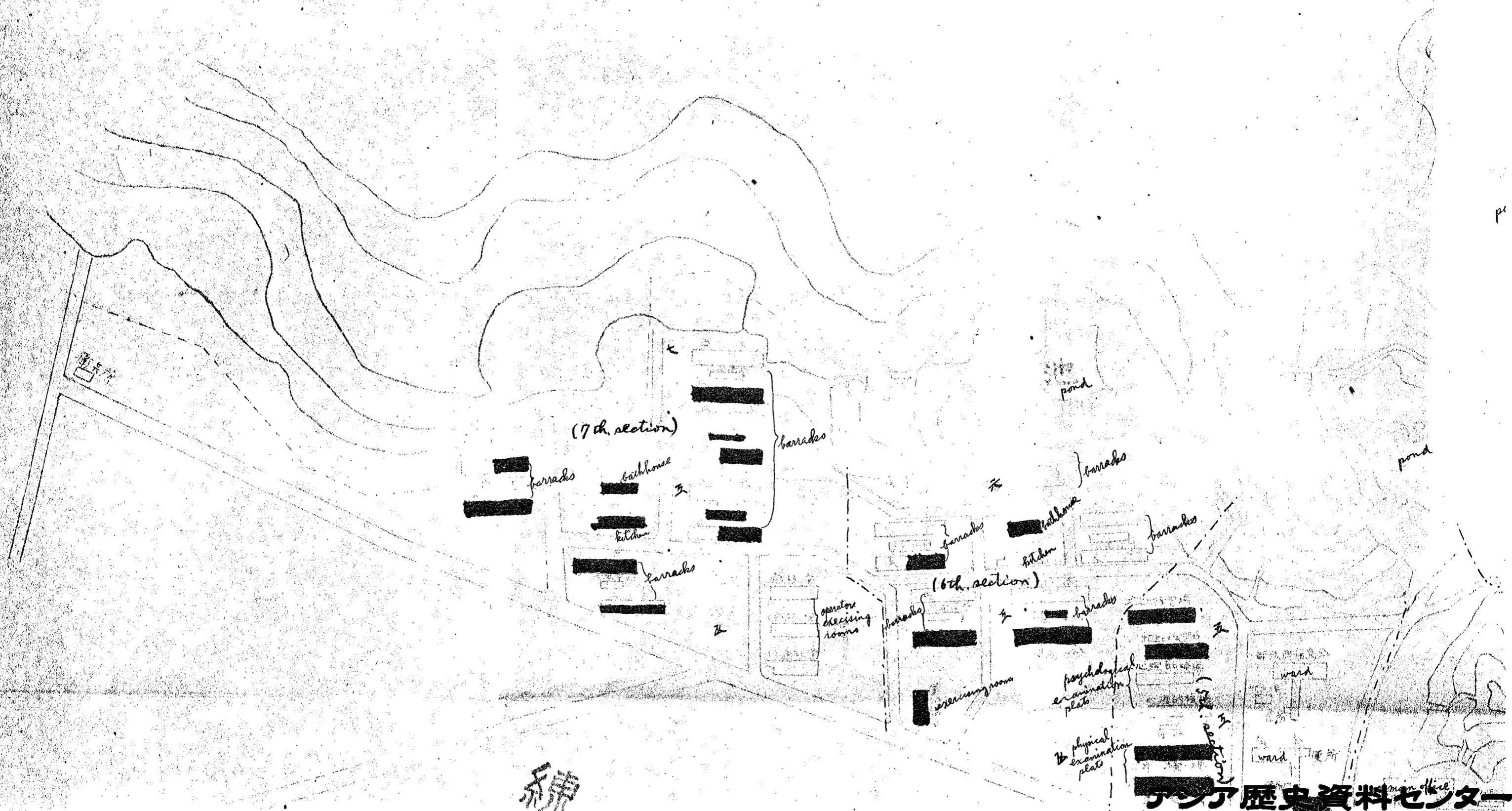

赤井

富士航空隊施設位置圖

(part, showing the position of equipments of Kofuji naval air-corps)

縮尺 $\frac{1}{3000}$
scale 1-3000



施設位置圖

equipments of Kofuji naval air corps

縮尺 $\frac{1}{3000}$
scale 1-3000



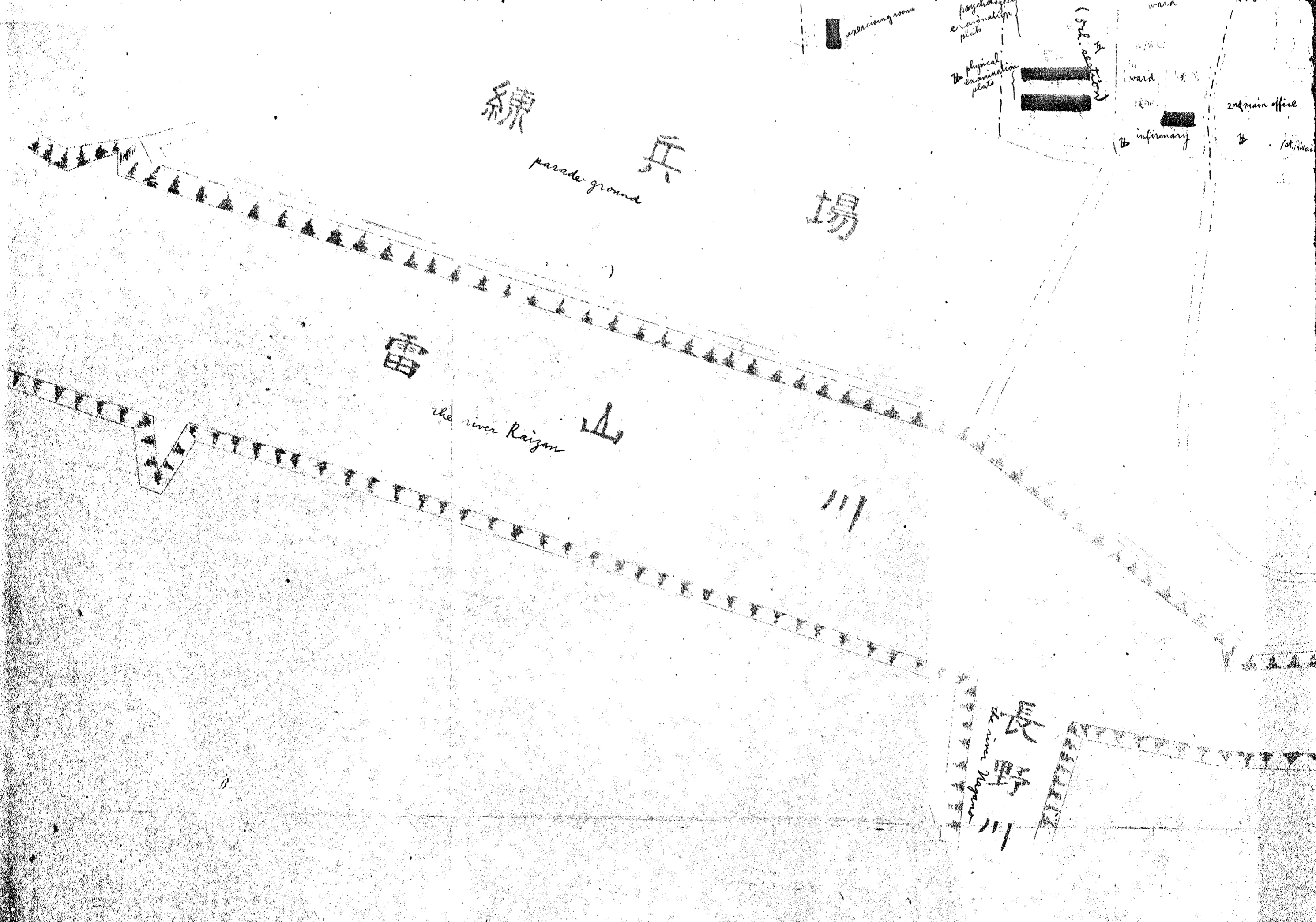



| | |
|-----------------------|-------|
| 敷地總坪數 | 約 16 |
| total area of site | about |
| 滑空場坪數 | 約 2 |
| area of glider ground | about |
| 練兵場坪數 | 約 1 |
| area of parade ground | about |

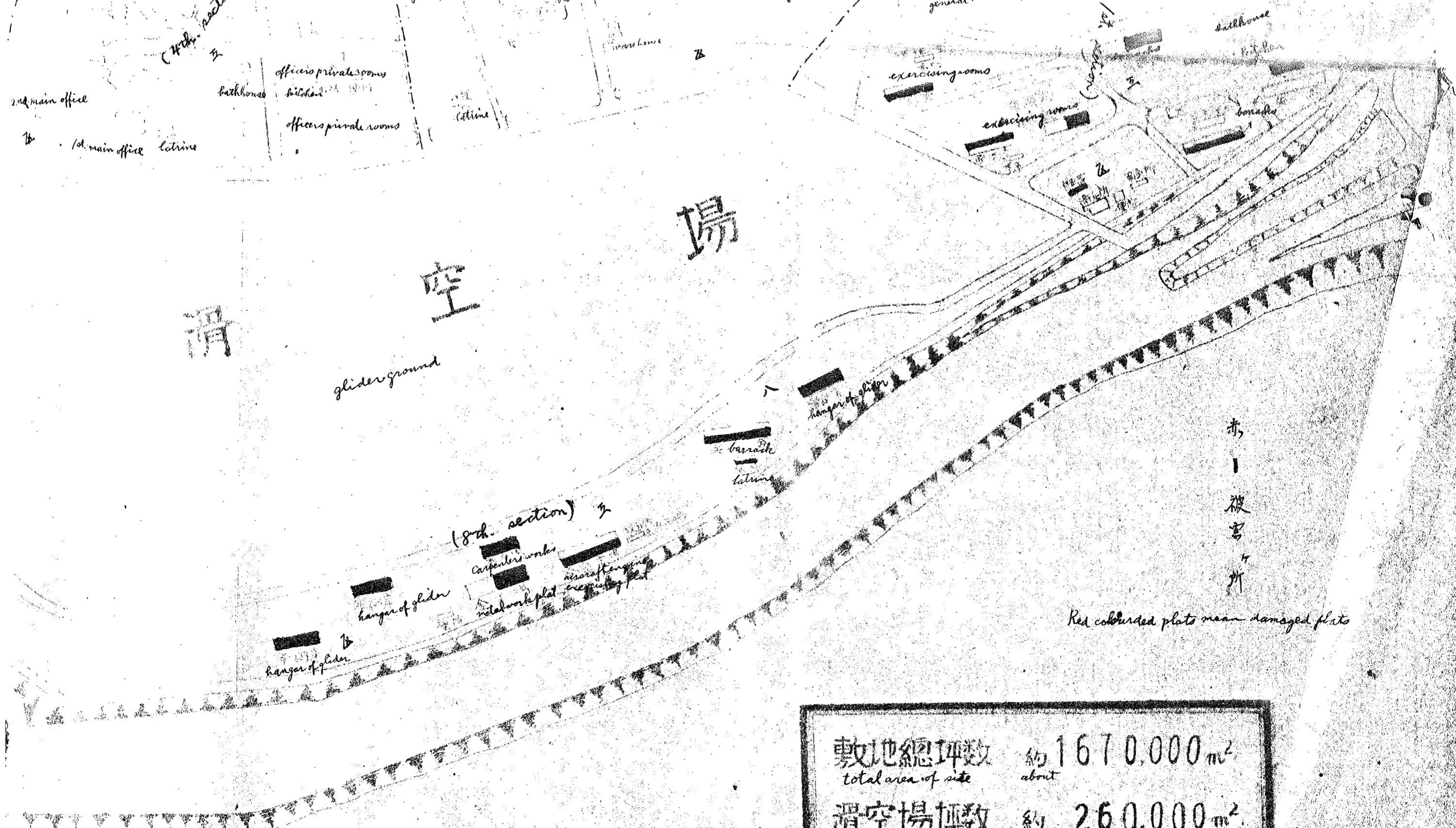

| | | |
|--------------------------------|------------|-------------------------|
| 敷地總坪數 total area of site | 約 about | 1670,000 m ² |
| 滑空場坪數 area of gliderground | 約 about | 260,000 m ² |
| 練兵場坪數 area of parade-ground | 約 about | 180,000 m ² |

0678

SUPPLEMENTARY
LIST

追加目録

KOFUJI
AIR CORPS

小富士航空隊

Clothing

被服之部

| Kinds | Quantity | Position | Note | 品名 | 数量 | 所在 | 記事 |
|-------------------------|----------|---------------------------|--------------|-------|-----|------|------|
| Cap | 700 | Ward-house of clothing in | second hands | 略 帽 | 700 | 返被服庫 | 取立古品 |
| sporting shoes | 800 | 2nd part | " | 略 靴 | 800 | " | " |
| fatigue Dress | 400 | " | " | 作業服衣袴 | 400 | " | " |
| Quilts | 14 | " | " | 綿蒲團 | 14 | " | " |
| Raincoat | 100 | " | " | 雨衣 | 100 | " | " |
| Mosquito-nets | 20 | " | " | 並蚊帳 | 20 | " | " |
| Mosquito-nets (for bed) | 30 | " | " | 寢台蚊帳 | 30 | " | " |
| Mantle | 15 | " | " | 當番外套 | 15 | " | 再用古品 |
| Patient-dress | 20 | " | " | 單長白衣 | 20 | " | " |
| Suspenders | 150 | " | new | 袴 釣 | 150 | " | 新品 |

(2)

0690

| Kinds | Quantity | Position | Note | 品名 | 数量 | 所在 | 記事 |
|-----------------------------|----------|-----------------------|--------------|-------|------|------|------|
| Pillow covers | 90 | Warehouse of clothing | new | 枕覆 | 90 | 正被服庫 | 新品 |
| Quilt covers | 10 | " | second hands | 薄團覆 | 10 | " | 取立古品 |
| Mantletie | 50 | " | new | 外套鉤 | 50 | " | 新品 |
| Socks | 2500 | " | second hands | 靴下 | 2500 | " | 修補用品 |
| lether Belts | 50 | " | " | 帶皮 | 50 | " | 取立古品 |
| "Kanshokushiki betamsho" | 1000 | " | " | 官職識別章 | 1000 | " | " |
| "Kakushiki sho" | 1000 | " | " | 各科識別章 | 1000 | " | " |

| Stor | | 需品之部 | | | | | |
|-----------|----------|--|------|--------|-----|----------------------------------|------|
| Kinds | Quantity | Position | Note | 品名 | 数量 | 所在 | 記事 |
| Desks (A) | 5 | 1st main office and officers private room | | 軍用机 甲 | 5 | 第一号倉 士官倉 | |
| Desks (B) | 20 | " | | " 乙 | 20 | 同上 | |
| Desks (C) | 20 | Warehouse of stor in 1st part and 9th Barrack in 2nd part | | " 丙 | 20 | 一区需品庫 二区九兵倉 | |
| Desks | 200 | 10th Barrack in 2nd Part | | 軍用教務机 | 200 | 二区十兵倉 | |
| Chair (A) | 30 | 1st main office and officers private room | | 軍用椅子 甲 | 30 | 第一号倉 士官倉 | |
| Tables | 10 | 1st Barrack in 3rd part | | 兵糞食卓 | 10 | 三区一兵倉 | |
| Benches | 20 | Infirmary and 9th Barrack in 2nd part | | " 長腰掛 | 20 | 病区九兵倉 | 食卓用 |
| Benches | 800 | 4th Barrack in 6th part 5th 6th Infirmary | | " | 800 | 六区四兵倉 六区六兵倉 六区五兵倉 六区八兵倉 | 教務机用 |
| Pillows A | 50 | Warehouse of stor in 2nd part | | 枕 甲 | 50 | 二三需品庫 | |

(3)

(4)

| Kind | Quantity | Position | Note | 品名 | 数量 | 所在 | 記事 |
|-----------------------|----------|--|------|---------|-----|--------------------|----|
| Beds B | 10 | 9th Barrack in 2nd part | | 寢台乙 | 10 | 二区九兵舎 | |
| double-beds B | 300 | Kitchen in 3 part, Infirmary 5, 6, 8 Barrack in 6 part and 3 Barrack in 7th part | | 軍用二重寢台乙 | 300 | 三区兵舎 病舎 | |
| wooden Tub | 1 | Kitchen in 2nd part | | 大平桶 | 1 | 六区五、六、八兵舎 七区三兵舎 | |
| Mimeographs | 2 | Warehouse of stor | | 騰寫版 | 2 | 需品庫 | |
| Films for Mimeographs | 4 | " " | | 騰寫版鏡 | 4 | " | |
| Bookcases | 3 | main office | | 軍用書棚 | 3 | 庁舎 | |
| Bookboards | 3 | " " | | " 戸棚 | 3 | " | |
| Phial boards | 2 | Infirmary | | 藥瓶棚 | 2 | 病舎 | |
| Ward Chest of Drawers | 1 | main office | | 洋服箆笥 | 1 | 庁舎 | |
| wash Basins | 40 | Warehouse of stor | | 手洗鉢 | 40 | 需品庫 | |
| Spoons | 5 | " " | | 兵食匙 | 5 | " | |
| Plates | 20 | " " | | 洋皿 | 20 | " | |

0682

0683

| Kind | Quantity | Position | Note | 品名 | 数量 | 所在 | 記事 |
|---------------|----------|---------------------|------|------|----|--------|----|
| Bowl B | 10 | Warehouse of stor | | 汁碗 乙 | 10 | 需品庫 | |
| Rice bowl B | 20 | " | | 飯碗 乙 | 20 | " | |
| Dish | 20 | " | | 中 皿 | 20 | | |
| Dish | 20 | " | | 小 皿 | 20 | | |
| Dish | 30 | " | | 刺身 皿 | 30 | | |
| Spittoon | 20 | " | | 唾壺 乙 | 20 | | |
| Mirror | 5 | " | | 鏡 小 | 5 | | |
| cooking-table | 2 | Kitchen in 2nd part | | 俎 大 | 2 | 二区兵員寮付 | |
| Waste case | 20 | Warehouse of stor | | 紙屑 入 | 20 | 需品庫 | |
| Tub | 2 | " | | 桶 大 | 2 | " | |
| Sofa | 3 | | | 長椅子 | 3 | | |
| Easy chair | 1 | | | 安樂椅子 | 1 | | |
| Seat box | 2 | | | 印 函 | 2 | | |

(5)

| Kinds | Quantity | Position | note | 品名 | 数量 | 所在 | 記事 |
|-------------------------|----------|----------------------|------|-------|-------|-----|----|
| Table-clothes | 3 | | | 食卓覆 | 3 | | |
| Desk-covers (| 4 | | | 机掛布 | 4 | | |
| wooden Box | 14 | | | 分隊函 | 14 | | |
| Cooking-pots | 2 | warehouse of stor | | 陸戦用釜 | 2 | 需品庫 | |
| Cooking-potstands | 3 | " | | 陸戦用釜掛 | 3 | | |
| china Pot | 30 | " | | 蓋 井 | 30 | | |
| Paper (Yoshi C) | 10000 | " | | 洋紙丙 | 10000 | | |
| copying papers | 3000 | " | | 原紙 | 3000 | | |
| section papers | 500 | " | | 方眼紙 | 500 | | |
| Blething papers | 40 | " | | 吸墨紙 | 40 | | |
| Papers (for typwriting) | 30 | " | | 外字原紙 | 30 | | |
| copying ink | 5 | " | | 騰寫版のキ | 5 | | |

0684

| Kinds | Quantity | Position | Note | 品名 | 数量 | 所在 | 記事 |
|--------------------|----------|-------------------|------|-----------------|------|-----|----|
| "Tsujiyama" C | 5 | warehouse of stor | | 綴金丙 | 5 | 需品庫 | |
| Papers (No. 67.80) | 1000 | " | | 兵備品 諸用紙第六十八号 | 1000 | 5 | |

0685

| Engine | | | | 發動機之部 | | | |
|----------------------|----------|----------------------------|------|---------|----|---------------|----|
| Kinds | Quantity | Position | Note | 品名 | 数量 | 所在 | 記事 |
| Kotobuki-41 Engine | 1 | 8th part | | 壽發動機四型 | 1 | 八区 | |
| Kinsei-41 Engine | 1 | " | | 金星發動機四型 | 1 | " | |
| Boat | | | | 短艇之部 | | | |
| Kinds | Quantity | Position | Note | 品名 | 数量 | 所在 | 記事 |
| 9 ^m Boats | 10 | Terayama 9 Kafuri 1 | | 九米カフタ | 10 | 寿山 9 四布屋 1 | |
| Sails | 2 | 3rd Barrack in 4th part | | 帆走用帆 | 2 | 四区三兵舎 | |
| Masts | 5 | " | | マスト | 5 | " | |
| Oars | 93 | " | | 橈 | 93 | " | |
| Lods | 17 | " | | 水竿 | 17 | " | |
| Anchors | 4 | " | | 錨 | 4 | " | |
| Rope | 10 | " | | 帆索 | 10 | " | |

4890

| Kinds | Quantity | Position | Note | 品名 | 数量 | 所在 | 記事 |
|---------------|----------|----------------------------|------|-----|----|-------|----|
| "Bogenbinten" | 80 | 3rd Barrack in 4th part | | 浮航物 | 80 | 四区三兵舎 | |
| Tillers | 6 | | | 舵柄 | 6 | | |
| Tub | 6 | | | 水吸 | 6 | | |

Besides

其他

| Kinds | Quantity | Position | Note | 品名 | 数量 | 所在 | 記事 |
|-------------------|----------|---------------------------------------|-----------|------|-----|---------|------|
| Fire-extinguisher | 100 | 3rd Barrack in 4th part | | 消火器 | 100 | 四区三兵舎 | |
| Stoves | 10 | Warehouse of "Kikanke" in 4th part | | ストーブ | 10 | 四区機内科倉庫 | |
| Kettle | 5 | 4th and 7th part | | 松根釜 | 5 | 四区七区 | |
| Boiler | 1 | 5th part | imperfect | 蒸気缶 | 1 | 五区 | 未完成品 |

(End)

(終)

List of arms

The 2nd. Kō-wa Flying Corps.
Fukae Air Base

(Fukae-mura,

Itoshima-gun, Fukuoka Pref.)

兵器目録

才二河和空
深江基地

| Rinds | Number | Position | Notes | 零式品名 | 数量 | 所在 | 記事 |
|--------------------------|--------|--------------------------------------|--|------------|------|------|--------------------|
| O type Observation | 5 | Fukae Base | heavily damaged 2 - float missing 1 - fallen | 零式観測機 | 5 | 深江基地 | 二基 大坂 浮舟 一基 陸路機 |
| Float for O type Obs. | 1 | " | | 零式観測機 浮舟 | 1 | " | |
| Zui-sei engines -13 | 2 | Fukae Station | | 瑞星 發動機 一三型 | 2 | 深江駅 | |
| Skid for O type Obs. | 32 | the Tak post in Kōshūji N.A.C. | | 零式観測機用橋 | 32 | 楠塚七巴 | |
| Carriers for O type Obs. | 3 | Fukae station | | 零式観測機用運搬車 | 3 | 深江駅 | |
| 60 Kg bombs | 1.00 | Fukae Base | | 60 磅 爆彈 | 1.00 | 深江基地 | |
| 250 Kg bombs | 60 | " | | 250 磅 爆彈 | 60 | " | |

6890

TRANSFER LIST
FOR
FUKUOKA PREFECTURE.

LIST OF UTENSILS
MACHINE LIST OF EACH FACTORY.

SASEBO NAVAL DOCK YARD.

海軍

0690

LIST OF UTENSILS.
SECTION OF FUKUOKA PREFECTURE

SASEBO NAVAL DOCK YARD.

海軍

アジア歴史資料センター

Japan Center for Asian Historical Records

<http://www.jacar.go.jp/>

List of instrument in Fukuoka Prefecture

Sasebo Naval Dock-yard

| Name of factory | Chuwo armor ur shares co. | Yastani iron factory | Nakano Seiki shares co. | Fukusami iron factory | Toyo Tan- zo factory | Tatal |
|--|---------------------------------|-------------------------|-------------------------------|--------------------------|-------------------------|-------|
| Needles, Nails, Pins | 0.3 | | 0.1 | | | 0.4 |
| Miscellaneous metal fittings for equipments | | .20 | .20 | .12 | | .52 |
| Polishing materials | 38 | 8 | 12 | 2 | 12 | 72 |
| Cotton, Silks, Wool | 370 | 60 | 60 | 144 | 444 | 1,078 |
| | 1,080 | | 30 | 40 | 2,500 | 3,650 |

| | | | | | | |
|---------------------------------------|-----|-----|-----|-----|-----|-----|
| Gauges | 27 | 23 | 22 | 15 | 120 | 207 |
| Conveying instruments | 60 | 140 | 60 | 75 | | 335 |
| Photographic instruments | 8 | | | | | 8 |
| Business instruments | 200 | 200 | 140 | | 120 | 660 |
| Instruments for special use | 3 | | 1 | 8 | 30 | 37 |
| General instruments | 300 | 80 | 75 | 100 | 160 | 715 |
| Miscellaneous instruments | 70 | 80 | 20 | 40 | 240 | 450 |
| Electric instruments | 10 | 1 | 1 | | | 12 |
| Instruments for electric arrangements | 3 | | | | | 3 |
| Mechanical constructing instruments | 210 | 90 | 50 | 50 | 40 | 440 |
| Manufacturing instruments | | | 1 | | | 1 |
| Auxiliary manufacturing instruments | 100 | 40 | 50 | 60 | 170 | 420 |
| Manufacturing tools | 15 | 20 | 18 | 32 | 9 | 94 |

0698

| | | | | | | |
|--|-----|-----|-----|-----|------|------|
| Cutlery for metal works | 450 | 100 | 110 | 250 | 1200 | 2110 |
| General cutlery | 8 | 1 | 1 | | | 5 |
| Weights and measures Test instruments | 6 | 8 | 4 | 2 | 37 | 57 |
| General meters | 50 | | | | | 50 |
| Special meters | 19 | 22 | 4 | 19 | 21 | 85 |
| Hides and skins | 5 | | | | 500 | 505 |
| General rubber | 45 | | 50 | 135 | | 230 |
| Stationery | 1 | | | 1 | | 2 |
| | | | | | | |
| | | | | | | |
| | | | | | | |
| | | | | | | |
| | | | | | | |



0694

MACHINE LIST OF EACH FACTORY.

SECTION OF FUKUOKA PREFECTURE.

SASEBO NAVAL DOCK YARD.

軍 務

アジア歴史資料センター

Japan Center for Asian Historical Records

<http://www.jacar.go.jp/>

List of machine in Fukuoka Prefecture

Sendo Naval Dock - Yard

| Name of factory | Name of Machine | Sendo Naval Dock - Yard | | | | | | | Total | | | | | | |
|-----------------|-----------------------------|-------------------------|------|--------------|-------------|---------|----------|----------|-------|---------|--------------|---------|--------|------|----------------|
| | | Kosuburo | K.K. | Chuo - Keiki | Seitan K.K. | Matouya | Tokuboku | Yasutani | | Kogyudo | Toya - Janyo | Tokkoku | Hiwami | K.K. | Nakano - Seiki |
| | Lathe | 2 | | 1 | | | | 1 | | 2 | | 1 | | | 64 |
| | Turret - Lathe | 2 | | | | | | | 2 | | | | | | 4 |
| | Horizontal drilling Machine | 1 | | | | | | | | | | | | | 1 |
| | Turning compressor | | | 1 | | | | | | | | | | | 1 |
| | Dropping hammer | | | | | 2 | | | | | | | | | 2 |
| | Graduating machine on disk | | | 1 | | | | 7 | | | | | | | 1 |

9690

| | | | | | | | | |
|----------------------------|--|---|--|---|---|---|---|---|
| Radial drilling machine | | | | 1 | | | | 1 |
| Slotting machine | | | | 1 | 3 | | | 4 |
| Universal milling machine | | | | | 3 | | | 3 |
| Vertical milling machine | | | | | 3 | | | 3 |
| Universal grinding machine | | | | | 3 | | | 3 |
| Shaping machine | | | | 1 | 2 | | 1 | 4 |
| Drilling machine | | 2 | | | 3 | | | 5 |
| Milling machine | | 2 | | 1 | | 1 | 1 | 5 |
| Blasting machine | | | | | | 1 | | 1 |
| | | | | | | | | |
| | | | | | | | | |
| | | | | | | | | |
| | | | | | | | | |
| | | | | | | | | |

0690

MACHINE LIST OF EACH FACTORY IN FUKUOKA-KEN

SASEHO NAVAL DOCK YARD

(MACHINES OF CONSTRUCTIVE BRANCH)

| NAMES NAME OF MACHINE | CITY WAKMATSU NAVAL STORE AT WAKAMATSU | CITY FUKUOKA FUKUOKA DOCK YARD | | | | | | | | | | | TOTAL | | |
|--------------------------|--|-----------------------------------|--|--|--|--|--|--|--|--|--|--|-------|--|---|
| | | | | | | | | | | | | | | | |
| CRANE | 1 | | | | | | | | | | | | | | 1 |
| AIR HAMMER | | 1 | | | | | | | | | | | | | 1 |
| AIR COMPRESSOR | | 1 | | | | | | | | | | | | | 1 |
| | | | | | | | | | | | | | | | |
| | | | | | | | | | | | | | | | |

SITUATION OF MASHINERY IN FUKUOKA PREFECTURE

ENGINEERING DEPT. SASKBO HANY YAN

0690

| Name of machine | NAME OF SHOP | | Total |
|----------------------------|--------------|--------------------|-----------|
| | Kabaru shop | Hainutsuka station | |
| Medium Lathe | 4 | | 4 |
| Small Lathe | 44 | | 44 |
| Vertical Lath | 2 | | 2 |
| Slotting machine | 1 | | 1 |
| Drilling machine | 2 | | 2 |
| Face boring machine | 1 | | 1 |
| Boring machine | 1 | | 1 |
| Vertical milling machine | 2 | | 2 |
| Horizontal milling machine | 2 | | 2 |
| Sawing machine | 1 | | 1 |
| Tool grinder | 2 | | 2 |
| Special machine | 1 | | 1 |
| Melting furnace | | 1 | 1 |
| TOTAL | 63 | 1 | 64 |

海 軍

6690

TRANSFER LIST
FOR
FUKUOKA PREFECTURE.

LIST OF UTENSILS
MACHINE LIST OF EACH FACTORY.

SASEBO NAVAL DOCK YARD.

海軍

アジア歴史資料センター

Japan Center for Asian Historical Records

<http://www.jacar.go.jp/>

0700

MACHINE LIST OF EACH FACTORY.

SECTION OF FUKUOKA PREFECTURE.

SASEBO NAVAL DOCK YARD.

車
機

アジア歴史資料センター

Japan Center for Asian Historical Records

<http://www.jacar.go.jp/>

List of machine in Fukuoka Prefecture

Sasebo Naval Dock-yard

| Name of factory | Name of Machine | Kokubanku | K.K.K. | Chuo Heiki | Matenya | Saitan K.K. | Togo - Togo | Nigata | Yamatori | Tokushu | Fukami | K.K. | Nakanu-shiki | Total |
|-----------------|----------------------------|-----------|--------|------------|---------|-------------|-------------|--------|----------|---------|--------|------|--------------|-------|
| | Lathe | 4 | | 2 | | | 3 | | 1 | | 1 | | | 64 |
| | Turret-Lathe | 2 | | | | | 1 | | | | | | | 4 |
| | Horisonal drilling Machine | 1 | | | | | | | | | | | | 1 |
| | Turning compressor | | | 1 | | | | | | | | | | 1 |
| | Dropping hammer | | | | 2 | | | | | | | | | 2 |
| | Graduating machine on disk | | | 1 | | | | | 1 | | | | | 1 |

| | | | | | | | | |
|----------------------------|--|---|--|---|---|---|---|---|
| Radial drilling machine | | | | / | | | | 1 |
| Slotting machine | | | | / | 3 | | | 4 |
| Universal milling machine | | | | | 3 | | | 3 |
| Vertical milling machine | | | | | 3 | | | 3 |
| Universal grinding machine | | | | | 3 | | | 3 |
| Shaping machine | | | | / | 2 | | / | 4 |
| Drilling machine | | 2 | | | 3 | | | 5 |
| Milling machine | | 2 | | / | | / | / | 5 |
| Planing machine | | | | | | / | | 1 |
| | | | | | | | | |
| | | | | | | | | |
| | | | | | | | | |
| | | | | | | | | |

MACHINE LIST OF EACH FACTORY IN FUKUOKA-KEN

SASEHO NAVAL DOCK YARD

(MACHINES OF CONSTRUCTIVE BRANCH.)

| NAMES NAME OF MACHINE | CITY WAKAMATSU NAVAL STORE AT WAKAMATSU | CITY FUKUOKA FUKUOKA DOCK YARD | | | | | | | | | | | | | | | | TOTAL |
|--------------------------|---|-----------------------------------|---|--|--|--|--|--|--|--|--|--|--|--|--|--|--|-------|
| | | | | | | | | | | | | | | | | | | |
| CRANE | 1 | | | | | | | | | | | | | | | | | 1 |
| AIR HAMMER | | | 1 | | | | | | | | | | | | | | | 1 |
| AIR COMPRESSOR | | | 1 | | | | | | | | | | | | | | | 1 |
| | | | | | | | | | | | | | | | | | | |
| | | | | | | | | | | | | | | | | | | |

0703

SITUATION OF MASHINERY IN FUKUOKA PREFECTURE

ENGINEERING DEPT., SASEBO NAVY YARD

| Name of machine | NAME OF SHOP | | Total |
|----------------------------|--------------|--------------------|-----------|
| | Kaharu shop | Hainutsuka station | |
| Medium Lathe | 4 | | 4 |
| Small Lathe | 44 | | 44 |
| Vertical Lathe | 2 | | 2 |
| Slotting machine | 1 | | 1 |
| Drilling machine | 2 | | 2 |
| Face boring machine | 1 | | 1 |
| Boring machine | 1 | | 1 |
| Vertical milling machine | 2 | | 2 |
| Horizontal milling machine | 2 | | 2 |
| Sawing machine | 1 | | 1 |
| Tool grinder | 2 | | 2 |
| Special machine | 1 | | 1 |
| Melting furnace | | 1 | 1 |
| TOTAL | 63 | 1 | 64 |

0704

海軍

0705

LIST OF UTENSILS.
SECTION OF FUKUOKA PREFECTURE

SASEBO NAVAL DOCK YARD.

海軍

アジア歴史資料センター

Japan Center for Asian Historical Records

<http://www.jacar.go.jp/>

0706

List of instrument in Fukuoka Prefecture
Sasebo Naval Dock-yard

| Name of factory Name of instrument | Chuwu arm- ur shares co. | Yastami iron factory | Nekano Seiki share co. | Fukusami iron factory | Toyo Tan- 30 factory | total |
|--|--------------------------------|-------------------------|------------------------------|--------------------------|-------------------------|-------|
| Needles, Nails, Pins | 0.3 | | 0.1 | | | 0.4 |
| Miscellaneous metal fittings for equipments | | .20 | .20 | .12 | | .52 |
| Polishing materials | 38 | 8 | 12 | 2 | 12 | 72 |
| Cotton, Silks, Wool | 370 | 60 | 60 | 144 | 444 | 1,078 |
| | 1,080 | | 80 | 40 | 2,500 | 3,650 |



| | | | | | | |
|---------------------------------------|-----|-----|-----|-----|-----|-----|
| Gauges | 27 | 23 | 22 | 15 | 120 | 207 |
| Conveying instruments | 60 | 140 | 60 | 75 | | 335 |
| Photographic instruments | 8 | | | | | 8 |
| Business instruments | 200 | 200 | 140 | | 120 | 660 |
| Instruments for special use | 3 | | 1 | 3 | 30 | 37 |
| General instruments | 300 | 80 | 75 | 100 | 160 | 715 |
| Miscellaneous instruments | 70 | 80 | 20 | 40 | 240 | 450 |
| Electric instruments | 10 | 1 | 1 | | | 12 |
| Instruments for electric arrangements | 3 | | | | | 3 |
| Mechanical constructing instruments | 210 | 90 | 60 | 60 | 40 | 460 |
| Manufacturing instruments | | | 1 | | | 1 |
| Auxiliary manufacturing instruments | 100 | 40 | 60 | 60 | 170 | 430 |
| Manufacturing tools | 15 | 20 | 18 | 32 | 9 | 94 |

0707

| | | | | | | |
|--|-----|-----|-----|-----|------|------|
| Cutlery for metal works | 450 | 100 | 110 | 250 | 1200 | 2110 |
| General cutlery | 2 | 1 | 1 | | | 5 |
| Weights and measures Test instruments | 6 | 8 | 4 | 2 | 37 | 57 |
| General meters | 50 | | | | | 50 |
| Special meters | 19 | 22 | 4 | 19 | 21 | 85 |
| Hides and skins | 5 | | | | 500 | 505 |
| General rubber | 45 | | 50 | 135 | | 230 |
| Stationery | 1 | | | 1 | | 2 |
| | | | | | | |
| | | | | | | |
| | | | | | | |
| | | | | | | |
| | | | | | | |

0708